

D Kegelsenker
DIN 335 C, 90°

E Countersinks
DIN 335 C, 90°

I Svasatori
DIN 335 C, 90°

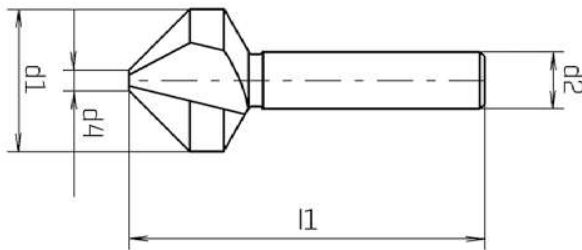
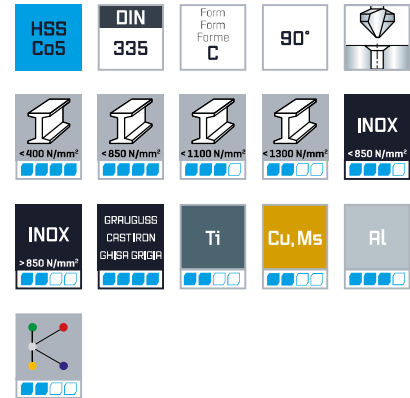

						ALUNIT®	
d1 mm		d2 _{h9} mm	d4 mm	l1 mm	Z	Code 2290 Art.-Nr.	Code 2297 Art.-Nr.
4,30	M 2	4,00	1,3	40	3	0229000430100	
5,00		4,00	1,5	40	3	0229000500100	0229700500100
5,30		4,00	1,5	40	3	0229000530100	
6,00		5,00	1,5	45	3	0229000600100	0229700600100
6,30	M 3	5,00	1,5	45	3	0229000630100	0229700630100
8,00		6,00	2	50	3	0229000800100	0229700800100
8,30	M 4	6,00	2	50	3	0229000830100	0229700830100
9,40		6,00	2,2	50	3	0229000940100	
10,00		6,00	2,5	50	3	0229001000100	0229701000100
10,40	M 5	6,00	2,5	50	3	0229001040100	0229701040100
11,50		8,00	2,8	56	3	0229001150100	
12,40	M 6	8,00	2,8	56	3	0229001240100	0229701240100
13,40		8,00	2,9	56	3	0229001340100	
15,00		10,00	3,2	60	3	0229001500100	0229701500100
16,50	M 8	10,00	3,2	60	3	0229001650100	0229701650100
19,00		10,00	3,5	63	3	0229001900100	0229701900100
20,50	M 10	10,00	3,5	63	3	0229002050100	0229702050100
23,00		10,00	3,8	67	3	0229002300100	
25,00	M 12	10,00	3,8	67	3	0229002500100	0229702500100
31,00		12,00	4,2	71	3	0229003100100	0229703100100



HSS-Senker und HSS-Reibahlen
HSS countersinks and HSS reamers
HSS svasatori e HSS alesatori