

**D** Kegelsenker mit MK-Schaft  
DIN 335 D, 90°



<b>HSS Co5</b>	<b>DIN 335</b>	Form Form Forme <b>D</b>	<b>90°</b>	
 <400 N/mm <sup>2</sup>	 <850 N/mm <sup>2</sup>	 <1100 N/mm <sup>2</sup>	 <1300 N/mm <sup>2</sup>	<b>INOX</b> <850 N/mm <sup>2</sup>
<b>INOX</b> >850 N/mm <sup>2</sup>	<b>GRAUGUSS CAST IRON GHISA GRIGIA</b>	<b>Ti</b>	<b>Cu, Ms</b>	<b>Al</b>

**E** Countersinks with MT-Shank  
DIN 335 D, 90°

**I** Svasatori cono morse  
DIN 335 D, 90°

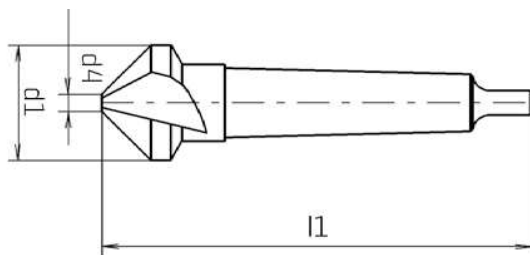

d1 mm	d4 mm	l1 mm		Z	Code 2330 Art.-Nr.
<b>25,00</b>	3,8	106	2	3	0233002500100
<b>31,00</b>	4,2	112	2	3	0233003100100
<b>34,00</b>	4,5	118	2	3	0233003400100
<b>37,00</b>	4,8	118	2	3	0233003700100
<b>40,00</b>	10	140	3	3	0233004000100
<b>50,00</b>	14	150	3	3	0233005000100