

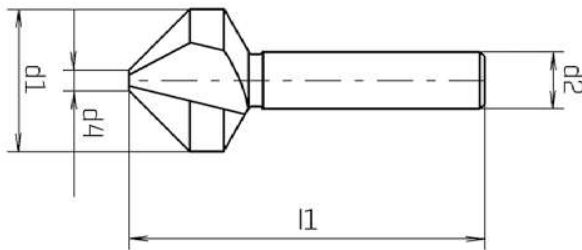

D HSS Cobalt Kegelsenker,
3-Flächenschaft, ungleiche
Teilung,
DIN 335 C, 90°

E HSS Cobalt countersinks,
3-surface shank, different
partition,
DIN 335 C, 90°

I Svasatori conici in acciaio
super-rapido al cobalto,
codolo a 3 superfici, con
passo irregolare,
DIN 335 C, 90°

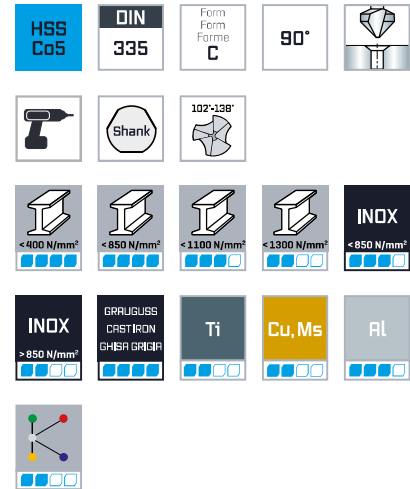

						ALUNIT®	
d1 mm		d2 _{h9} mm	d4 mm	l1 mm	Z	Code 2380 Art.-Nr.	Code 2387 Art.-Nr.
4,30	M 2	4,00	1,3	40	3	0238000430100	0238700430100
6,00	M 3	5,00	1,5	45	3	0238000600100	0238700600100
6,30	M 3	5,00	1,5	45	3	0238000630100	0238700630100
8,00	M 4	6,00	2	50	3	0238000800100	0238700800100
8,30	M 4	6,00	2	50	3	0238000830100	0238700830100
10,00	M 5	6,00	2,5	50	3	0238001000100	0238701000100
10,40	M 5	6,00	2,5	50	3	0238001040100	0238701040100
11,50	M 6	8,00	2,8	56	3	0238001150100	0238701150100
12,40	M 6	8,00	2,8	56	3	0238001240100	0238701240100
15,00	M 8	10,00	3,2	60	3	0238001500100	0238701500100
16,50	M 8	10,00	3,2	60	3	0238001650100	0238701650100
19,00	M 10	10,00	3,5	63	3	0238001900100	0238701900100
20,50	M 10	10,00	3,5	63	3	0238002050100	0238702050100
23,00	M 12	10,00	3,8	67	3	0238002300100	0238702300100
25,00	M 12	10,00	3,8	67	3	0238002500100	0238702500100
31,00	M 16	12,00	4,2	71	3	0238003100100	0238703100100



HSS-Senker und HSS-Reibahlen
HSS countersinks and HSS reamers
HSS svasatori e HSS alesatori