

D HSS Cobalt Kegelsenker,
ungleiche Teilung
DIN 335 C, 90°

E HSS Cobalt countersinks,
different partition
DIN 335 C, 90°

I Svasatori HSS Cobalt
disuguale tagliente
DIN 335 C, 90°



Material and performance icons:

- HSS Co5
- DIN 335
- Form Forme Forme C
- 90°
- 102°-138°
- <400 N/mm²
- <850 N/mm²
- <1100 N/mm²
- <1300 N/mm²
- <850 N/mm²
- INOX >850 N/mm²
- GRAUGUSS CAST IRON G-HSA GRICIA
- Ti
- Cu, Ms
- AL

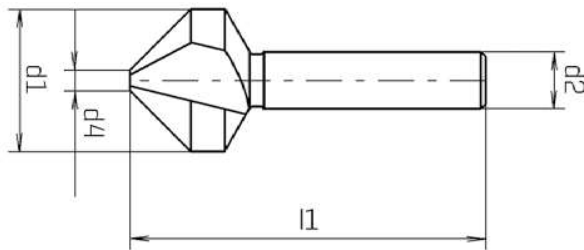

						ALUNIT®	
d1 mm		d2 _{h9} mm	d4 mm	l1 mm	Z	Code 2390 Art.-Nr.	Code 2397 Art.-Nr.
4,30	M 2	4,00	1,3	40	3	0239000430100	0239700430100
6,00	M 3	5,00	1,5	45	3	0239000600100	0239700600100
6,30	M 3	5,00	1,5	45	3	0239000630100	0239700630100
8,00	M 4	6,00	2	50	3	0239000800100	0239700800100
8,30	M 4	6,00	2	50	3	0239000830100	0239700830100
10,00	M 5	6,00	2,5	50	3	0239001000100	0239701000100
10,40	M 5	6,00	2,5	50	3	0239001040100	0239701040100
11,50	M 6	8,00	2,8	56	3	0239001150100	0239701150100
12,40	M 6	8,00	2,8	56	3	0239001240100	0239701240100
15,00	M 8	10,00	3,2	60	3	0239001500100	0239701500100
16,50	M 8	10,00	3,2	60	3	0239001650100	0239701650100
19,00	M 10	10,00	3,5	63	3	0239001900100	0239701900100
20,50	M 10	10,00	3,5	63	3	0239002050100	0239702050100
23,00	M 12	10,00	3,8	67	3	0239002300100	0239702300100
25,00	M 12	10,00	3,8	67	3	0239002500100	0239702500100
31,00	M 16	12,00	4,2	71	3	0239003100100	0239703100100