

D VHM-Viertelrund-Profil-Fräser

E Solid carbide quarter circle cutters

I Frese a profilo raggiato MDI



VHM Carbide MDI **Z=4** **Typ Type Tipo N**
WN
INOX
INOX >850 N/mm² **GRAUGUSS CAST IRON GHEB GRGGR** **Cu, Ms** **Al**

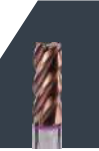

VHM-Fräser
Solid carbide milling cutters
Frese in metallo duro integrale

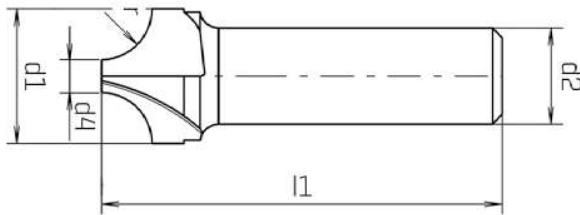

ALUNIT®

r mm	d1 _{h10} mm	d2 _{h6} mm	d4 mm	l1 mm	Z	Code 6415 Art.-Nr.	Code 6417 Art.-Nr.
1	8,00	8,00	6	64	4	0641500100100	0641700100100
1,5	8,00	8,00	5	64	4	0641500150100	0641700150100
2	8,00	8,00	4	64	4	0641500200100	0641700200100
2,5	10,00	10,00	5	67	4	0641500250100	0641700250100
3	10,00	10,00	4	67	4	0641500300100	0641700300100
3,5	12,00	12,00	5	74	4	0641500350100	0641700350100
4	12,00	12,00	4	74	4	0641500400100	0641700400100
5	16,00	16,00	6	83	4	0641500500100	0641700500100
6	16,00	16,00	4	83	4	0641500600100	0641700600100
8	26,50	20,00	10,5	85	4	0641500800100	0641700800100
10	32,00	20,00	12	85	4	0641501000100	0641701000100
12	38,00	20,00	14	90	4	0641501200100	0641701200100

≤ R 6 = VHM / Solid carbide / MDI

> R 8 = nur VHM-Kopf / only solid carbide cutting part / parte taglianti metallo duro integrale

Eignung der Beschichtung: finden Sie in der Materialübersicht / Suitability of the coating: can be found in the material overview / Idoneità del rivestimento: si trova nella panoramica dei materiali